



LED

TECHNOLOGIES

KOMPONENTE ZA LED RASVETU

TAGOR

www.tagor.rs

LED RASVETA - KOMPONENTE

1. POWER LED – EDISON



1.1 PLCC 3528 serija

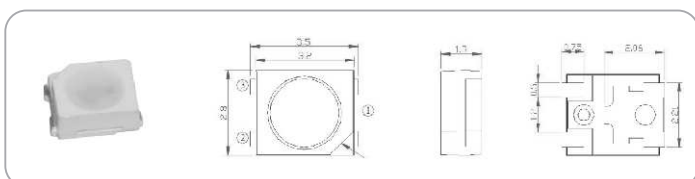

OEPLED	Power LED, 0.5W, PLCC 3528 serija	10+	1000+
ET-3528X-AE1W	Warm white, 3000, 150mA, 18lm, 120°	0.44	0.33
ET-3528H-AE1W	Natural white, 4500K, 150mA, 23lm, 120°	0.44	0.33
ET-3528W-AB1W	Cool white, 6500K, 150mA, 26lm, 120°	0.44	0.33
ET-3528R-A11W	Red, 150mA, 10lm, 120°	0.44	0.33
ET-3528T-A11W	Green, 150mA, 19lm, 120°	0.44	0.33
ET-3528B-A11W	Blue, 150mA, 6lm, 120°	0.44	0.33

1.2 PLCC 5050 serija 0.5W

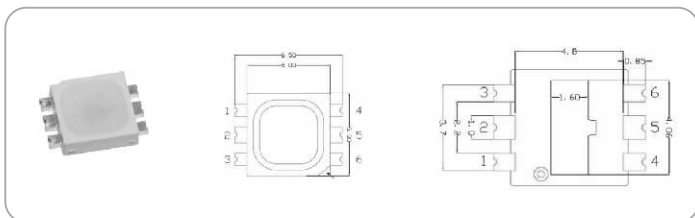

OEPLED	Power LED, 0.5W, PLCC 5050 serija	10+	1000+
ET-5050X-AE1W	Warm white, 3000, 150mA, 28lm, 120°	0.44	0.33
ET-5050H-AE1W	Natural white, 4500K, 150mA, 31lm, 120°	0.44	0.33
ET-5050W-AB1W	Cool white, 6500K, 150mA, 35lm, 120°	0.44	0.33

1.3 PLCC 5050 serija 1W

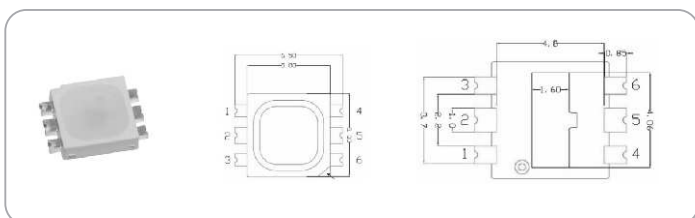

OEPLED	Power LED, 1W, PLCC 5050 serija	10+	1000+
ET-5050X-BE1W	Warm white, 3000, 350mA, 68lm, 120°	1.21	0.90
ET-5050H-BE1W	Natural white, 4500K, 350mA, 76lm, 120°	1.21	0.90
ET-5050W-BB1W	Cool white, 6500K, 350mA, 85lm, 120°	1.21	0.90
ET-5050R-B11W	Red, 350mA, 34lm, 120°	1.21	0.90
ET-5050A-B11W	Amber, 350mA, 33lm, 120°	1.21	0.90
ET-5050T-B11W	Green, 350mA, 52lm, 120°	1.21	0.90
ET-5050B-B11W	Blue, 350mA, 15lm, 120°	1.21	0.90
ET-5050RTB-B11W	RGB, 3x100mA, R8lm G15lm B5lm, 120°	0.84	0.63

1.4 Edixeon A serija

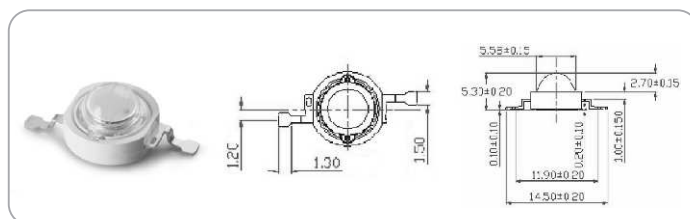

OEPLED	Power LED, Edixeon A serija	10+	1000+
Edixeon A 1W			
EDEX-1LA1-E1	Warm white, 3000K, 350mA, 75lm, 135°	2.2	1.6
EDEH-1LA5-E1	Natural white, 4500K, 350mA, 85lm, 120°	2.2	1.6
EDEW-1LA5-B1	Cool white, 6500K, 350mA, 100lm, 135°	2.2	1.6
EDER-1LA3	Red, 350mA, 50lm, 120°	2.2	1.6
EDEA-1LA3	Amber, 350mA, 45lm, 120°	2.2	1.6
EDET-1LA2	Green, 350mA, 70lm, 150°	2.2	1.6
EDEB-1LA5	Blue, 350mA, 20lm, 150°	2.2	1.6
Edixeon A 3W			
EDEX-3LA1-E3	Warm white, 3000K, 700mA, 130lm, 135°	2.7	2.0
EDEH-3LA1-E3	Natural white, 4500K, 700mA, 150lm, 135°	2.7	2.0
EDEW-3LA3-E1	Cool white, 6500K, 700mA, 170lm, 135°	2.7	2.0
EDER-3LA3-1	Red, 700mA, 85lm, 120°	2.7	2.0
EDET-3LA1-1	Green, 700mA, 120lm, 150°	2.7	2.0
EDEB-3LA1	Blue, 700mA, 30lm, 150°	2.7	2.0

1.5 Edixeon S serija

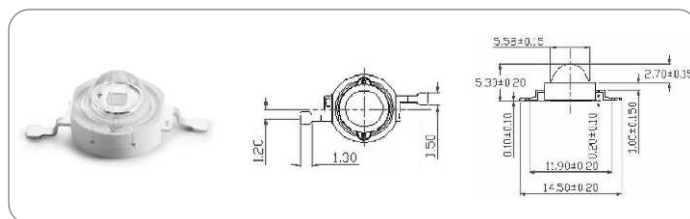

OEPLED	Power LED, Edixeon S serija	10+	1000+
Edixeon S 1W			
EDEX-1LS5-E1	Warm white, 3000, 350mA, 75lm, 120°	2.5	1.9
EDEH-1LS5-E1	Natural white, 4500K, 350mA, 85lm, 120°	2.5	1.9
EDEW-1LS5-B1	Cool white, 6500K, 350mA, 100lm, 120°	2.5	1.9
EDER-1LS3	Red, 350mA, 50lm, 120°	2.5	1.9
EDEA-1LS3	Amber, 350mA, 45lm, 120°	2.5	1.9
EDET-1LS1	Green, 350mA, 70lm, 150°	2.5	1.9
EDEB-1LS5	Blue, 350mA, 20lm, 150°	2.5	1.9
Edixeon S6 1W			
EDEX-1LS6-E1	Warm white, 3000, 350mA, 80lm, 120°	2.5	1.9
EDEH-1LS6-E1	Natural white, 4500K, 350mA, 90lm, 120°	2.5	1.9
EDEW-1LS6-B1	Cool white, 6500K, 350mA, 110lm, 120°	2.5	1.9
Edixeon S 3W			
EDEX-3LS5-E3	Warm white, 3000, 700mA, 130lm, 120°	3.0	2.3
EDEH-3LS5-E3	Natural white, 4500K, 700mA, 150lm, 120°	3.0	2.3
EDEW-3LS5-B3	Cool white, 6500K, 700mA, 170lm, 120°	3.0	2.3
EDER-SLC3-03	Red, 700mA, 85lm, 120°	3.0	2.3
EDET-SLC5-03	Green, 700mA, 120lm, 150°	3.0	2.3
EDEB-SLC5-03	Blue, 700mA, 30lm, 150°	3.0	2.3
Edixeon S6 3W			
EDEX-3LS6-E3	Warm white, 3000, 700mA, 140lm, 120°	2.5	1.9
EDEH-3LS6-E3	Natural white, 4500K, 700mA, 160lm, 120°	2.5	1.9
EDEW-3LS6-B3	Cool white, 6500K, 700mA, 190lm, 120°	2.5	1.9

2. EDISON - MODULI

2.1 Modul serija EdiLine III

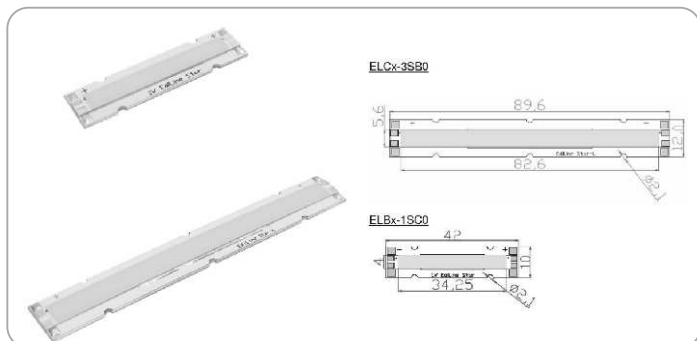

OEPLED	Power LED modul EdiLine serija	1+	50+
EdiLine III 1W			
ELBX-1SC0-E00	Warm white, 3000K, 350mA, 70lm, 120x140°	3.0	2.3
ELBH-1SC0-E00	Natural white, 4500K, 350mA, 80lm, 120x140°	3.0	2.3
ELBW-1SC0-B00	Cool white, 6500K, 350mA, 100lm, 120x140°	3.0	2.3

EdiLine III 3.5W

ELCX-3SB0-E00	Warm white, 3000K, 350mA, 230lm, 120x140°	10	7.5
ELCH-3SB0-E00	Natural white, 4500K, 350mA, 260lm, 120x140°	10	7.5
ELCW-3SB0-B00	Cool white, 6500K, 350mA, 330lm, 120x140°	10	7.5

2.2 Modul serija EdiPower

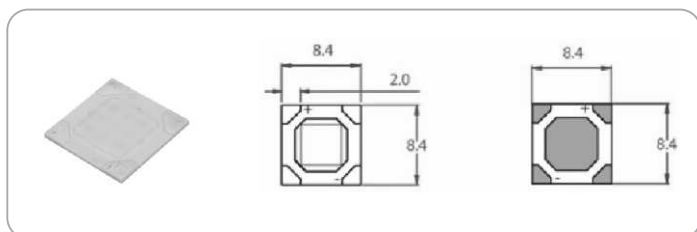

OEPLED	Power LED modul EdiPower serija	1+	50+
EdiPower 5W			
EP5X-4E04-E2	Warm white, 3000K, 700mA, 250lm, 130°	call	call
EP5H-4E04-E2	Natural white, 4500K, 700mA, 300lm, 130°	call	call
EP5W-4E04-B2	Cool white, 6500K, 700mA, 350lm, 130°	call	call

2.3 Modul serija EdiPower

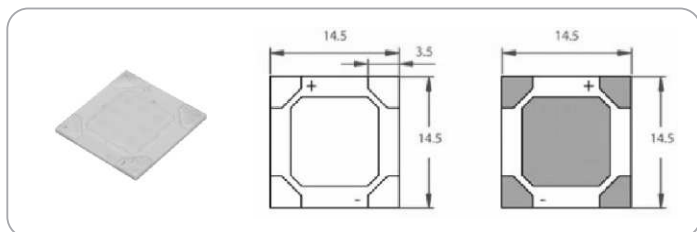

OEPLED	Power LED modul EdiPower serija	1+	50+
EdiPower 10W			
EPAX-4E02-E2	Warm white, 3000K, 1050mA, 600lm, 130°	call	call
EPAH-4E02-E2	Natural white, 4500K, 1050mA, 700lm, 130°	call	call
EPAW-4E02-B2	Cool white, 6500K, 1050mA, 800lm, 130°	call	call

EdiPower 15W			
EPLX-4E02-E2	Warm white, 3000K, 1400mA, 750lm, 130°	call	call
EPLH-4E02-E2	Natural white, 4500K, 1400mA, 900lm, 130°	call	call
EPLW-4E02-B2	Cool white, 6500K, 1400mA, 1050lm, 130°	call	call

EdiPower 20W			
EPBX-4S02-E2	Warm white, 3000K, 1400mA, 1100lm, 130°	22	17
EPBH-4S02-E2	Natural white, 4500K, 1400mA, 1300lm, 130°	22	17
EPBW-4S02-B2	Cool white, 6500K, 1400mA, 1500lm, 130°	22	17

2.4 Modul serija EdiStar

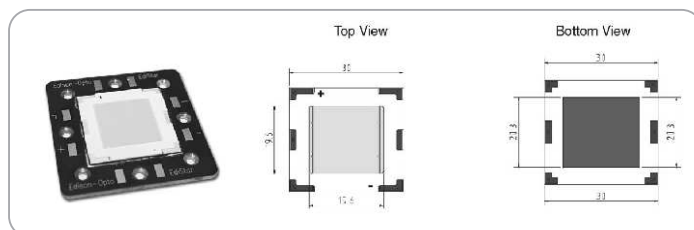

OEPLED	Power LED modul EdiStar serija	1+	50+
--------	--------------------------------	----	-----

EdiStar 50W

ENSX-05-0707-EE	Warm white, 3000K, 2.4A, 2800lm, 130°	105	78
ENSH-05-0707-EE	Natural white, 4500K, 2.4A, 3200lm, 130°	105	78
ENSW-05-0707-EB	Cool white, 6500K, 2.4A, 4000lm, 130°	105	78

EdiStar 100W

ENSX-10-0707-EE	Warm white, 3000K, 3.0A, 4900lm, 130°	call	call
ENSH-10-0707-EE	Natural white, 4500K, 3.0A, 5600lm, 130°	call	call
ENSW-10-0707-EB	Cool white, 6500K, 3.0A, 7500lm, 130°	call	call

2.5 Modul za ulicnu rasvetu 27W

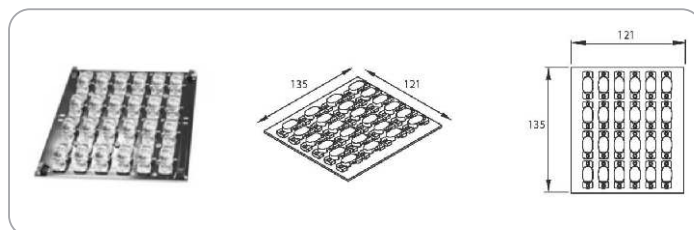

OEPLED	Power LED modul 27W	1+	50+
EMPX-A51J09G	Warm white, 3000K, 1.4A, 1200lm, 130x50°	118	88
EMPH-A51J09G	Natural white, 4500K, 1.4A, 1400lm, 130x50°	118	88
EMPW-A51J09G	Cool white, 6500K, 1.4A, 2000lm, 130x50°	118	88

2.6 Modul za ulicnu rasvetu - cirkularni

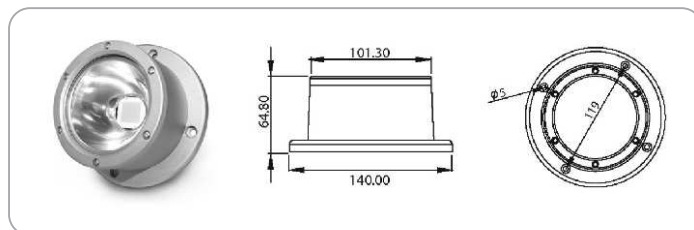

OEPLED	Power LED modul EDIS - cirkularni	1+	50+
--------	-----------------------------------	----	-----

Edis 50W

EDIS-M050-X10	Warm white, 3000K, 2.4A, 2500lm, 100°	143	107
EDIS-M050-H10	Natural white, 4500K, 2.4A, 2700lm, 100°	143	107
EDIS-M050-W10	Cool white, 6500K, 2.4A, 3000lm, 100°	143	107

Edis 100W

EDIS-M100-X10	Warm white, 3000K, 3.0A, 4200lm, 100°	202	151
EDIS-M100-H10	Natural white, 4500K, 3.0A, 4650lm, 100°	202	151
EDIS-M100-W10	Cool white, 6500K, 3.0A, 5200lm, 100°	202	151



2.7 Modul za ulicnu rasvetu - elipsasti

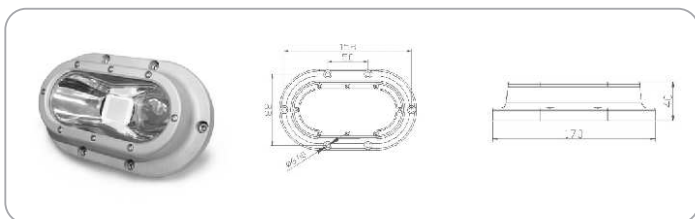

OEPLED Power LED modul EDIS - elipsasti 1+ 50+

Edis 50W			
EDIS-M050-X20	Warm white, 3000K, 2.4A, 2500lm, 120x90°	143	107
EDIS-M050-H20	Natural white, 4500K, 2.4A, 2700lm, 120x90°	143	107
EDIS-M050-W20	Cool white, 6500K, 2.4A, 3000lm, 120x90°	143	107

Edis 100W			
EDIS-M100-X20	Warm white, 3000K, 3.0A, 4200lm, 120x90°	202	151
EDIS-M100-H20	Natural white, 4500K, 3.0A, 4650lm, 120x90°	202	151
EDIS-M100-W20	Cool white, 6500K, 3.0A, 5200lm, 120x90°	202	151

2.8 Modul Low / High bay 50W

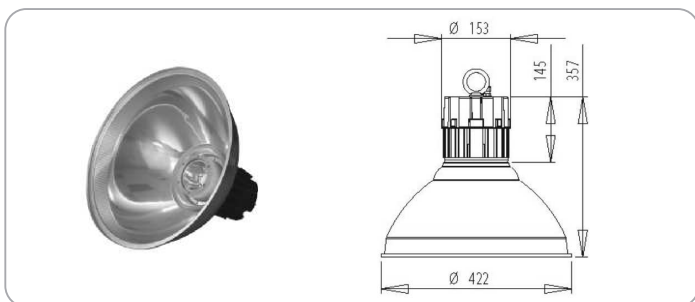

OEPLED Power LED modul – Low / High bay 1+ 50+

EB1X-0500	Warm white, 3000K, 2.4A, 2200lm, 100°	204	152
EB1H-0500	Natural white, 4500K, 2.4A, 2300lm, 100°	204	152
EB1W-0500	Cool white, 6500K, 2.4A, 2700lm, 100°	204	152

2.9 Modul Low / High bay 100W

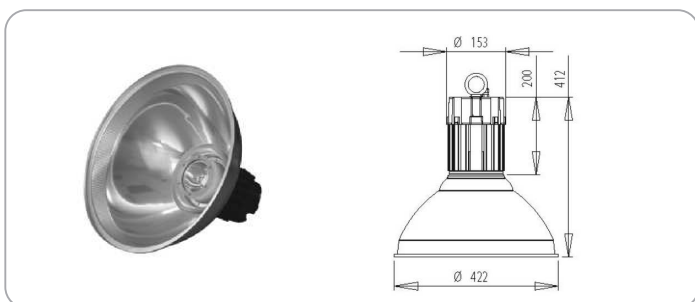

OEPLED Power LED modul – Low / High bay 1+ 50+

EB1W-1000	Warm white, 3000K, 3.0A, 3600lm, 100°	283	211
EB1W-1000	Natural white, 4500K, 3.0A, 4100lm, 100°	283	211
EB1W-1000	Cool white, 6500K, 3.0A, 5000lm, 100°	283	211



3. EDISON - OPTIKA



3.1 Sociva za power LED



A1550-M14 AA25-M12 AA38-M11 AA45-M11



AA45-R11 AB35-M15 AT50-M15 AT3060-M15

OEPLED Power LED sociva 10+ 500+

EDOL-AT08-M15	White housing, 8° clear	0.98	0.65
EDOL-AA15-M15	White housing, 15° clear	0.79	0.52
EDOL-AA25-M12	Black housing, 25° clear	0.79	0.52
EDOL-AA38-M11	Black housing, 38° clear	0.79	0.52
EDOL-AA38-R11	Black housing, 38° clear	0.98	0.65
EDOL-AA45-M11	Black housing, 45° smooth	0.79	0.52
EDOL-AA45-R11	Black housing, 45° flood	0.79	0.52
EDOL-AT50-M15	White housing, 50° clear	1.57	1.04
EDOL-AT60-M15	White housing, 60° clear	1.57	1.04
EDOL-AT75-M15	White housing, 70° clear	1.57	1.04
EDOL-AA1550-M14	White housing, 15x50° clear	0.79	0.52
EDOL-AA3060-M15	White housing, 30x60° clear	0.79	0.52

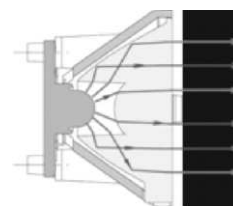

3.2 Difuzori



FOLIJA



TABLA

OEPLED Power LED difuzori 1+ 50+

DIF-ROLNA	Secenje na meru
DIF-SHEET	Secenje na meru

4. EDISON – EDIXEON MODULI

4.1 Modul Edixeon - okrugli

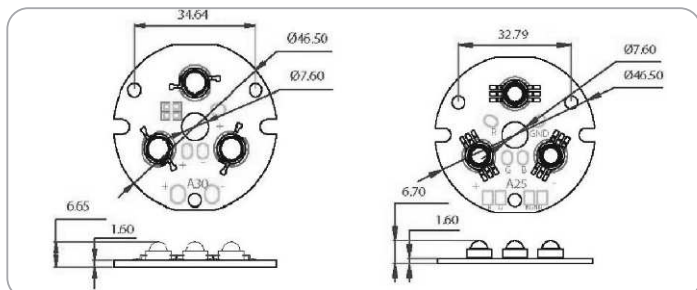

OELED	Modul Edixeon okrugli	1+	50+
EMCx-A30000C	Ø46.5x1.6mm; 3 pLED serijski	10	8
FMCRTB-A25000C	Ø46.5x1.6mm; 3 pLED serijski po boji	call	call
FMCx-A13000C	Ø52.5x1.6mm; 4 pLED serijski	14	10

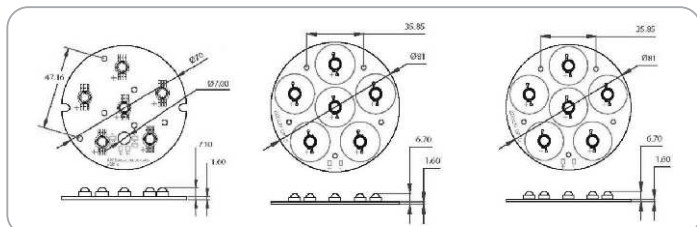

OELED	Modul Edixeon okrugli	1+	50+
FMCRTB-A44000C	Ø70x2.0mm; 6 pLED serijski po boji	call	call
EMCx-A44000C	Ø70x2.0mm; 6 pLED serijski	14	10
EMCx-A7000C	Ø81x1.6mm; 6 pLED serijski	14	10

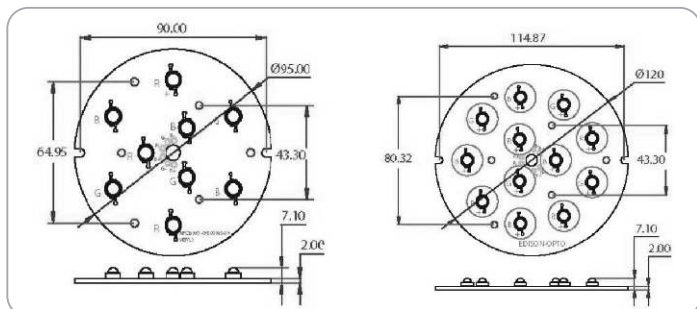

OELED	Modul Edixeon okrugli	1+	50+
EMCx-A43000C	Ø95x2.0mm; 3 pLED serijski po boji	20	15
EMCx-A45000C	Ø120x2.0mm; 4 pLED serijski po boji	25	19

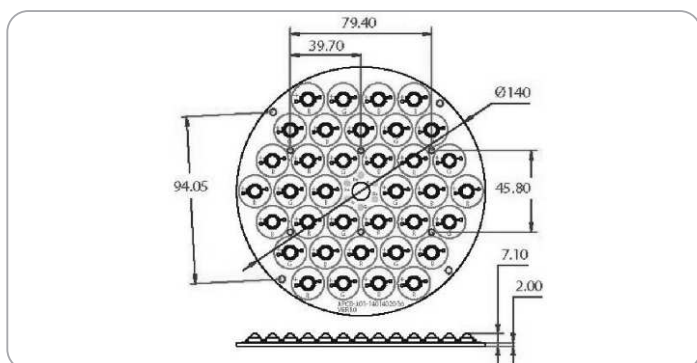

OELED	Modul Edixeon okrugli	1+	50+
EMCx-A42000G	Ø140x2.0mm; 2 pLED paralelno i 6 serijski	93	69

4. EDISON – EDIXEON MODULI



4.2 Modul Edixeon - prstenasti

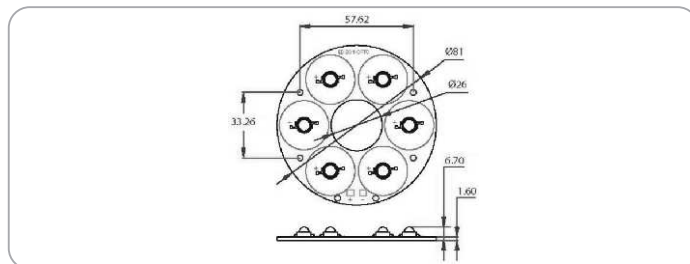

OELED	Modul Edixeon prstenasti	1+	50+
EMRx-A17000C	Ø81x1.6mm; 6 pLED serijski	14	10

4.3 Modul Edixeon - linijski

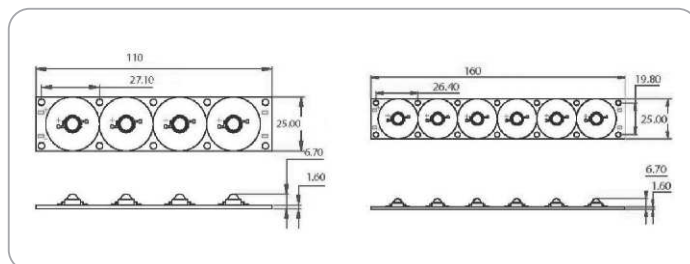

OELED	Modul Edixeon linijski	1+	50+
EMLx-A6000C	110x25x1.6mm; 4 pLED serijski	12	9
EMLx-A11000C	160x25x1.6mm; 6 pLED serijski	14	10
EMLx-A12000G	300x25x1.6mm; 2 pLED paralelno i 6 serijski	25	19

4.4 Modul Edixeon - kvadratni

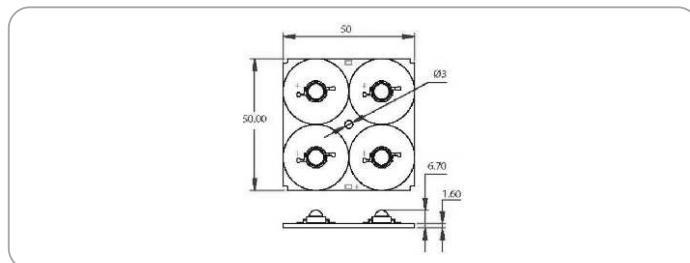

OELED	Modul Edixeon linijski	1+	50+
EMPx-A5000C	50x50x1.6mm; 4 pLED serijski	12	9
APSB-A01	132x75x2.0mm; 4 pLED paralelno i 7 serijski	call	call

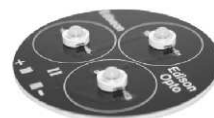

5. VS LED Moduli CA

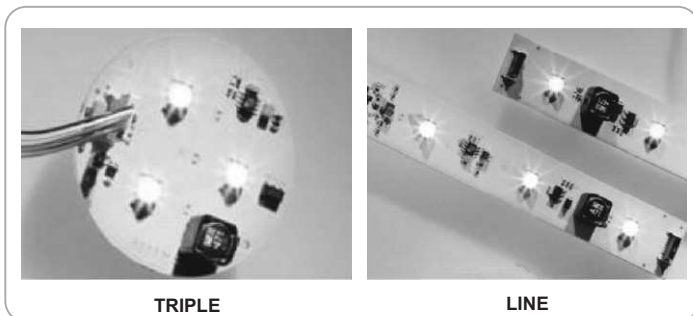

TRIPLE

LINE

OEPLED	LED Modules - 24V DC High Power Mono CA	1+	100+
--------	---	----	------

Mono Triple

360-W1	White, 3 LEDs, 0.42A, 421lm, 90°	38	29
360-W2	White, 3 LEDs, 0.42A, 497lm, 90°	40	30
360-WW1	Warm white, 3 LEDs, 0.42A, 310lm, 90°	38	29
360-WW2	Warm white, 3 LEDs, 0.42A, 359lm, 90°	40	30
360-SO	Read, 3 LEDs, 0.31A, 158lm, 100°	31	23
360-SG	Green, 3 LEDs, 0.42A, 325lm, 100°	38	29
360-SB	Blue, 3 LEDs, 0.42A, 126lm, 100°	38	29

Mono Line

361-W1	White, 6 LEDs, 0.83A, 815lm, 90°	69	52
361-W2	White, 6 LEDs, 0.83A, 963lm, 90°	74	55
361-WW1	Warm white, 6 LEDs, 0.83A, 581lm, 90°	69	52
361-WW2	Warm white, 6 LEDs, 0.83A, 718lm, 90°	74	55
361-SO	Read, 6 LEDs, 0.63A, 306lm, 100°	53	40
361-SG	Green, 6 LEDs, 0.83A, 603lm, 100°	69	52
361-SB	Blue, 6 LEDs, 0.83A, 227lm, 100°	69	52

Mono Flood

362-W1	White, 10 LEDs, 0.83A, 1087lm, 90°	93	69
362-W2	White, 10 LEDs, 0.83A, 1177lm, 90°	100	75
362-WW1	Warm white, 10 LEDs, 0.83A, 775lm, 90°	93	69
362-WW2	Warm white, 10 LEDs, 0.83A, 927lm, 90°	100	75
362-SO	Read, 10 LEDs, 0.73A, 528lm, 100°	65	49
362-SG	Green, 10 LEDs, 0.83A, 966lm, 100°	92	69
362-SB	Blue, 10 LEDs, 0.83A, 338lm, 100°	93	69

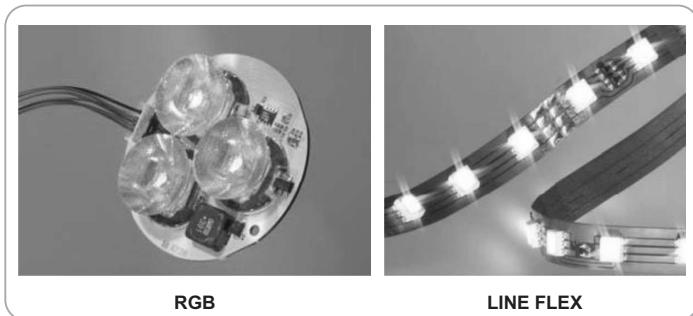

RGB

LINE FLEX

OEPLED	LED Modules - 24V DC High Power RGB CA	1+	100+
--------	--	----	------

RGB

340-RGB	Triple, RGB, 56/112/46 lm, 100°, 5W	32	24
341-RGB	Line, RGB, 112/224/92 lm, 100°, 15W	66	50
342-RGB	Flood, RGB, 168/448/138 lm, 100°, 25W	103	77

Line Flex

266-RGB2-52	Indor,RGB, 528,853,193 lm, 110°,L-4104mm	706	528
266-RGB2-95	Outdoor,RGB,22,36,8 lm, 110°,L-171mm	51	38
266-RGB2-96	Outdoor,RGB,110,180,40 lm, 110°,L-855mm	200	150
266-RGB2-97	Outdoor,RGB,220,360,80 lm, 110°,L-1710mm	381	285

6. VS LED Moduli Standard

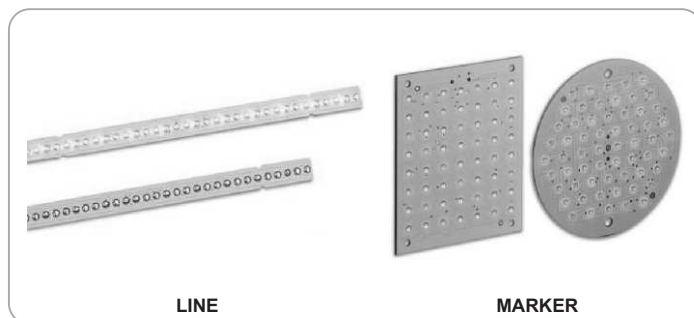

LINE

MARKER

OEPLED	LED Modules - 24V DC Standard	1+	100+
--------	-------------------------------	----	------

Line 150x10mm

306-RGB	RGB, 30 LEDs, 0.1A, 33lm, 170°	35	26
306-SO	Read, 10 LEDs, 0.02A, 12lm, 170°	12	9
306-SG	Green, 10 LEDs, 0.02A, 15lm, 170°	21	15
306-SB	Blue, 10 LEDs, 0.02A, 5lm, 170°	21	15
306-W-6	White, 10 LEDs, 0.04A, 15lm, 100°	23	17
311-W-3	Warm white, 30 LEDs, 0.12A, 36lm, 170°	45	34
311-W-4	Neutral white, 30 LEDs, 0.12A, 45lm, 170°	41	31
311-W-6	White, 30 LEDs, 0.12A, 41lm, 170°	41	31

Line 300x10mm

305-RGB	RGB, 60 LEDs, 0.2A, 65lm, 170°	49	37
305-SO	Read, 20 LEDs, 0.04A, 29lm, 170°	15	11
305-SG	Green, 20 LEDs, 0.04A, 10lm, 170°	27	20
305-SB	Blue, 20 LEDs, 0.04A, 25lm, 170°	27	20
305-W-4	Neutral white, 20 LEDs, 0.08A, 30lm, 170°	30	23
310-W-4	Neutral white, 60 LEDs, 0.24A, 90lm, 170°	53	39
310-W-6	White, 60 LEDs, 0.24A, 81lm, 170°	56	42

Marker Ø 50mm, Ø 80mm

245-RGB	RGB, 30 LEDs, 0.075A, 43lm,170°,Ø 50mm	36	27
245-SO	Read, 30 LEDs, 0.06A, 35lm,170°,Ø 50mm	28	21
245-SG	Green, 30 LEDs, 0.09A, 38lm,170°,Ø 50mm	46	34
245-SB	Blue, 30 LEDs, 0.09A, 12lm,170°,Ø 50mm	46	34
245-W-5	White,30, 0.09A, 33lm,170°,Ø 50mm	50	37
246-RGB	RGB, 60 LEDs, 0.15A, 86lm,170°,Ø 80mm	67	50
246-SO	Read, 60 LEDs, 0.12A, 70lm,170°,Ø 80mm	56	34
246-SG	Green, 60 LEDs, 0.18A, 77lm,170°,Ø 80mm	83	62
246-SB	Blue, 60 LEDs, 0.18A, 24lm,170°,Ø 80mm	83	62
246-W-5	White,60, 0.18A, 65lm,170°,Ø 80mm	89	66

Marker Square 88x75mm

267-RGB	RGB, 56 LEDs, 0.2A, 55lm, 170°	62	47
267-SO	Read, 25 LEDs, 0.06A, 37lm, 170°	25	19
267-SG	Green, 25 LEDs, 0.1A, 45lm, 170°	42	31
267-SB	Blue, 25 LEDs, 0.1A, 13lm, 170°	42	31
267-W-5	White,25, 0.1A, 45lm, 170°	47	65

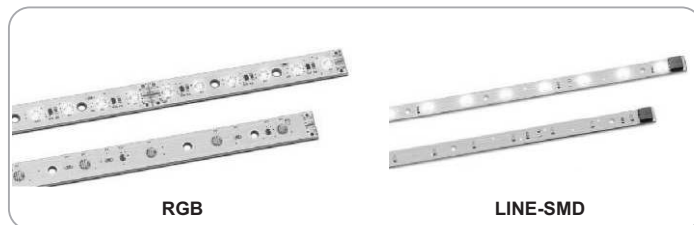

RGB

LINE-SMD

OEPLED	LED Modules - 24V DC Easy	1+	100+
--------	---------------------------	----	------

RGB

335-RGB	RGB, 60 LEDs, 22/42/11 lm, 130°	33	25
336-RGB	RGB, 30 LEDs, 11/21/5 lm, 130°	19	14

Line-SMD

242-W-5	White, 5 LEDs, 0.03A,10lm, L-175mm	13	10
242-W-10	White, 10 LEDs, 0.06A,18lm, L-350mm	21	16
225-W-48	White, 48 LEDs, 0.16A,80lm, L-420mm	69	51
225-W-24	White, 24 LEDs, 0.1A,36lm, L-420mm	36	27
177-W	White, 18 LEDs, 0.075A,39lm, L-450mm	26	19

LED RASVETA - KOMPONENTE

7. VS LED KONTROLERI CA



MANUAL ST-001

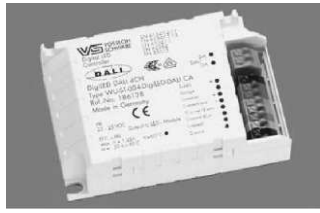

DALI ST-004

OEPLED	LED Kontroleri - 24V DC DigiLED CA	1+	25+
ST-001	Manual color controls, 1.25A/channel	69	52
ST-004D	Digital color controls, 1.25A/channel, Dali intrf.	83	62



IR ST-005



DMX ST-003

OEPLED	LED Kontroleri - 24V DC DigiLED CA	1+	25+
ST-005	Color controls, 1.25A/channel, IR remote cont.	98	73
ST-003	Digital color controls, 1.25A/channel, DMX intrf.	75	56



PUSH ST-006



MONO ST-010

OEPLED	LED Kontroleri - 24V DC DigiLED CA	1+	25+
ST-006	Color controls, 1.25A/channel, push button	22	16
ST-010	Diming single color LED moduls, 5A/chn.	16	12



ST-002

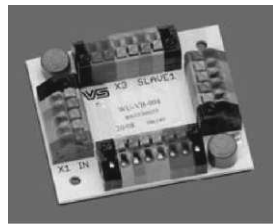

SLAVE PCB ST-004

OEPLED	LED Kontroleri - 24V DC DigiLED CA	1+	25+
ST-002	Signal amplification on chn. RGB, 1.25A/chn.	54	41
ST-011	No signal amplification on chn. RGB	11	8
ST-004S	No signal amplification on chn. RGB	8	6

8. VS LED KONTROLERI STANDARD



MANUAL ST-MNL



ST-DMX

OEPLED	LED Kontroleri - DigiLED Standard	1+	25+
ST-MNL	Manual color controls	69	52
ST-DMX	Digital color controls, DMX intrf.	75	56



SLAVE ST-SLV



CONTROL ST-CCM

OEPLED	LED Kontroleri - DigiLED Standard	1+	25+
ST-SLV	Color controls over upstreamed DigiLED.	50	37
ST-CCM	Color controls by 1-10V intrf. 1A / conductor	59	44



IR ST-IRC



ST-DALI

OEPLED	LED Kontroleri - DigiLED Standard	1+	25+
ST-IRC	Color controls, IR remote control	98	73
ST-DALI	Digital color controls, DALI intrf.	83	62



RF ST-008

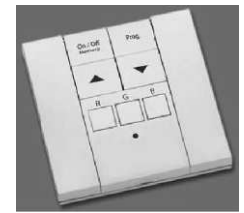

WALLTRANSMITTER ST-009

OEPLED	LED Kontroleri - DigiLED Standard	1+	25+
ST-008	Color controls, RF remote control., 1A/chn.	100	75
ST-009	Walltransmitter, remote control	65	49

LED RASVETA - KOMPONENTE

9. IC DRAJVERI



HV9910BNG

CL6/CL7

HV9922N8-G

IC...	LED Driver	1+	100+
Supertex			
HV9910BNG	Universal, 8-450V Buck mode, ext FET, dim	1.16	0.87
HV9911NG	Switch mode, Boost-Buck, ext FET, PWM dim	1.46	1.09
HV9921N3	3 pin switch mode, 85-264V, 20mA	0.73	0.54
HV9922N3	3 pin switch mode, 85-264V, 50mA	0.79	0.59
HV9923N3	3 pin switch mode, 85-264V, 30mA	0.75	0.56
HV9930L	Boost-Buck mode, 8-200V, ext.FET PWM dim	1.14	0.85
HV9931LG	Unity Power Factor LED Lamp Driver	1.14	0.85
HV9961NG-G	Led driver with average mode CC control	1.97	1.47
HV9963NG-G	Closed Loop Led driver & enhanced PWM dimm.	1.08	0.81
CL6	Linear, fixed constant current 100mA, 6.5-90V	1.49	1.11
NXP			
SSL1522T	Switch mode, 80-270V, 15W	1.47	0.97
SSL1623PH	Switch mode, 80-270V, 25W	2.02	1.32
SSL1750T	Switch mode ext FET, 70-270V, 250W	3.16	2.08
ONS			
NCP3065D	Switch mode, 3-40V, 1.5A, dimming	1.67	1.09
NCP1013ST	Switch mode Low standby SMPS	0.77	0.58
NCP1028P	Switch mode 15W	1.75	1.30
NUD4001DR	Linear High current, 500mA	1.043	0.78
NCP1216P	PWM Current mode controller	0.87	0.65
Maxim			
MAX16822	Step down, 6-65V, 350mA	2.26	1.69
MAX16832	Step down, 6-65V, 700mA	3.01	2.25
MAX16818	Step down, 6-65V, 500mA, dimming	4.04	3.01
STM			
L6902	Switch step down regulator, 8-36V, 1A	1.97	1.47
L5973D	Switch step down regulator, 4-36V, 2.5A	1.97	1.47
ST1S10	Switch step down regulator, 2.5-36V, 3A	3.95	2.60
L6726A	Single phase PWM controller, 5-12V	0.82	0.61
TI			
TPS61029DR	Boost converter, 1-6.5V, 800mA	3.31	2.18
TPS61054DR	Boost converter, 1-6.5V, 700mA, dimming	3.81	2.51
TPS63000DR	Step down converter, 2-6V, 600mA	4.91	3.23
TPS61050DR	Buck-Boost converter, 1.8-5.5V, 1200mA	3.81	2.51
TPS40211DR	Boost converter I2C, 5V, 1200mA	2.85	1.88

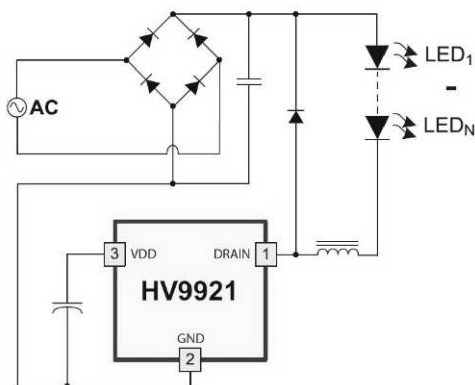

Supertex inc.

10. KONVERTORI

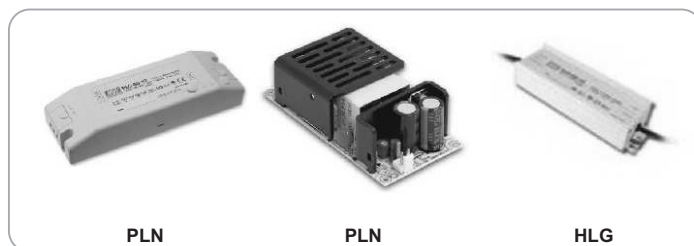

PLN

PLN

HLG

PRN...	Pretvarac napona	1+	5+
Mean Well			
CLG-60-12	Universal AC input. Output 12V, 5.0A	63	53
CLG-60-15	Universal AC input. Output 15V, 4.0A	53	45
CLG-60-20	Universal AC input. Output 20V, 3.0A	63	53
CLG-60-24	Universal AC input. Output 24V, 2.5A	63	53
PLN-30-9	Universal AC input. Output 9V, 3.3A	35	29
PLN-30-12	Universal AC input. Output 12V, 2.5A	35	29
PLN-30-15	Universal AC input. Output 15V, 2.0A	35	29
PLN-30-24	Universal AC input. Output 24V, 1.25A	35	29
PLN-60-12	Universal AC input. Output 12V, 5.0A	52	43
PLN-60-15	Universal AC input. Output 15V, 4.0A	52	43
PLN-60-24	Universal AC input. Output 24V, 3.0A	52	43
PLP-60-48	Universal AC input. Output 48V, 1.3A	26	22
HLG-100-24	Universal AC input. Output 24V, 4.0A	94	78
HLG-150-24	Universal AC input. Output 24V, 6.3A	106	88
HLG-240-24	Universal AC input. Output 24V, 10.0A	117	97



MEAN WELL

EXCELSYS

PRN...	Pretvarac napona	1+	5+
Excelsys			
LXC30-1660	Universal AC input. Output 9-18V, 1.6A	68	57
LXC30-1250	Universal AC input. Output 12-24V, 1.2A	68	57
LXC50-2770	Universal AC input. Output 9-18V, 2.7A	87	72
LXC50-1400	Universal AC input. Output 18-36V, 1.4A	87	72
LXV100-12S	Universal AC input. Output 12V, 8.0A	158	131
LXV100-24S	Universal AC input. Output 24V, 4.0A	158	131
LXV200-012	Universal AC input. Output 12V, 16.0A	281	234
LXV200-024	Universal AC input. Output 24V, 8.0A	281	234
LXV300-012	Universal AC input. Output 12V, 25.0A	341	284
LXV300-024	Universal AC input. Output 24V, 12.0AA	341	284



RC-24-0.35

RC-24-0.35W

PRN...	Pretvarac napona	5+	100+
Recom			
RCD-24-0.35	DC Inp. 4.5-36V, Out. curr. 350mA, Dimming	17	11
RCD-24-0.50	DC Inp. 4.5-36V, Out. curr. 500mA, Dimming	17	11
RCD-24-0.70	DC Inp. 4.5-36V, Out. curr. 700mA, Dimming	17	11
RCD-24-1.00	DC Inp. 4.5-36V, Out. curr. 1.0A, Dimming	17	11
RCD-24-1.20	DC Inp. 4.5-36V, Out. curr. 1.2A, Dimming	17	11
RCD-24-0.35W	DC Inp. 4.5-36V, Out. curr. 350mA	17	11
RCD-24-0.50W	DC Inp. 4.5-36V, Out. curr. 500mA	17	11
RCD-24-0.70W	DC Inp. 4.5-36V, Out. curr. 700mA	17	11
RCD-24-1.00W	DC Inp. 4.5-36V, Out. curr. 1.0A	17	11
RCD-24-1.20W	DC Inp. 4.5-36V, Out. curr. 1.2A	17	11

11. DEMO KIT

Supertex inc.



HV9903DB1 HV9910BDB2 HV9910BDB7

RAZ	LED SUPERTEX Demo kit	1+
Supertex		
HV9903DB1	White LED driver demoboard	69
HV9910BDB2	Universal voltage OFF-Line LED driver demoboard	92
HV9910BDB3	Low voltage, High current LED driver demoboard	92
HV9910BDB7	HV9910B PFC 40W LED driver demoboard	100

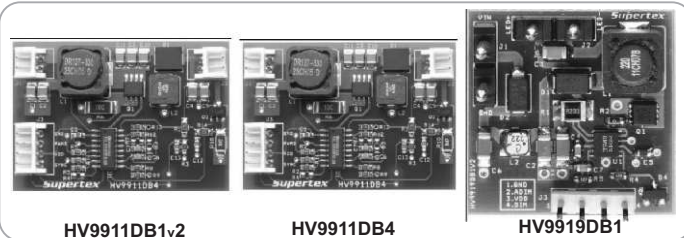

HV9911DB1v2 HV9911DB4 HV9919DB1

RAZ	LED SUPERTEX Demo kit	1+
Supertex		
HV9911DB1v2	Boost LED driver with dimming demoboard	92
HV9911DB2	Boost LED driver with dimming demoboard	92
HV9911DB4	SEPIC LED driver with dimming demoboard	92
HV9912DB1	Boost LED driver with dimming, hiccup mode protection	92
HV9919DB1	Single, high current LED driver demoboard	92

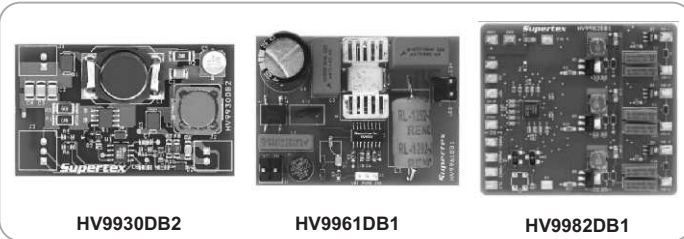

HV9930DB2 HV9961DB1 HV9982DB1

RAZ	LED SUPERTEX Demo kit	1+
Supertex		
HV9930DB2	Boost-Buck LED driver demoboard	92
HV9961DB1	21W Universal AC LED driver demoboard	92
HV9982DB1	Three channel LED driver demoboard	183

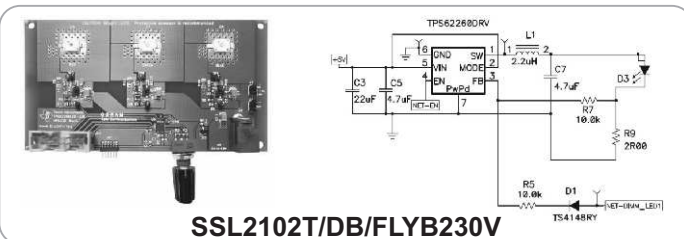

SSL2102T/DB/FLYB230V

RAZ	LED TI Demo kit	1+
TI		
TPS62260DB	Boost converter, 1-6.5V, 800mA	25

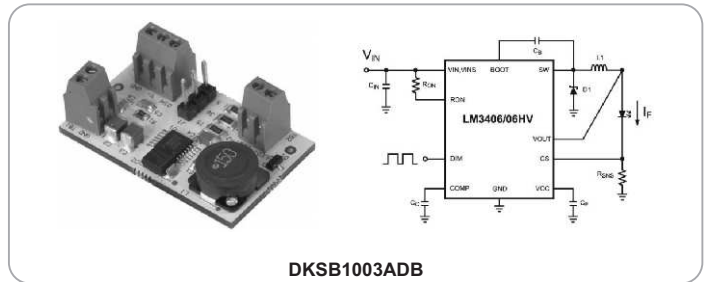

DKSB1003ADB

RAZ-	LED Demo kit	1+
DB		
DKSB1003ADB	LED demo board 350mA, 750mA, 1.5A	26

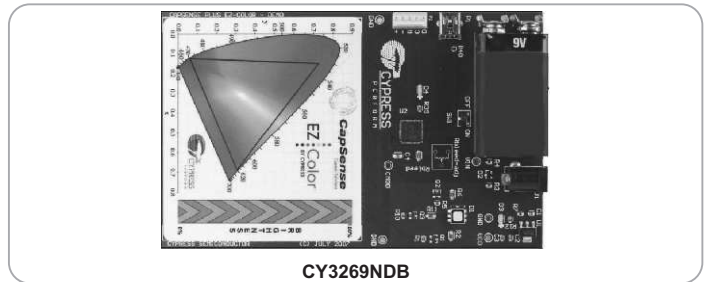

CY3269NDB

RAZ-	LED Demo kit	1+
Cypres		
CY3269NDB	CY3269N Lighting CapSense demo kit	45



ILL008V1DB

RAZ-	LED Demo kit	1+
ST		
ILL008V1DB	ST LED light demo kit	33

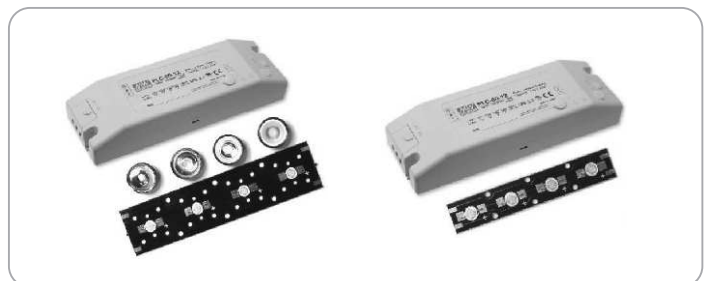

RAZ-	LED kit	1+
Tagor		
TAG-100-11	Pow-PLN-30-12, LED-1LS5, Lens-AA25, Pcb	56
TAG-100-12	Pow-PLN-30-12, LED-1LS5, Lens-AA38, Pcb	56
TAG-100-13	Pow-PLN-30-12, LED-1LS5, Lens-AA45, Pcb	56
TAG-100-14	Pow-PLN-30-12, LED-1LS5, Lens-AT60, Pcb	58
TAG-100-31	Pow-PLN-30-12, LED-3LS5, Lens-AA25, Pcb	58
TAG-100-32	Pow-PLN-30-12, LED-3LS5, Lens-AA38, Pcb	58
TAG-100-33	Pow-PLN-30-12, LED-3LS5, Lens-AA45, Pcb	58
TAG-100-34	Pow-PLN-30-12, LED-3LS5, Lens-AT60, Pcb	60
TAG-200-11	Pow-PLN-30-12, LED-1LS5-X-E1, Pcb	50
TAG-200-12	Pow-PLN-30-12, LED-1LS5-W-B1, Pcb	50
TAG-200-13	Pow-PLN-30-12, LED-1LS5-H-E1, Pcb	50

12. KONEKTORI

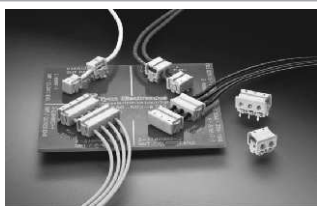

SSL IDC



BOARD TO BOARD

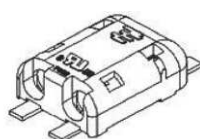

SMT POKE

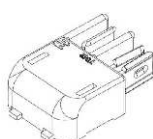

BLADE & RCPT

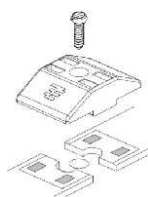

BOARD - BOARD

LLKNT-TYCO	SMT Poke + BLADE AND RCPT konektor	1+	100+
1-1954289-1	Blade and Rcpt 2 pos Black	0.43	0.32
1954289-3	Blade and Rcpt 6 pos White	1.42	1.06
1-1954289-2	Blade and Rcpt 4 pos Black	0.86	0.64
1954289-1	Blade and Rcpt 2 pos White	0.43	0.32
2106154-1	Jumper 2 pos Board to Board	1.05	0.78
1-2008683-1	1Pos LIF SMT Poke-In, BLK	0.51	0.38
1-2008683-2	2 Pos LIF SMT Poke-In, BLK	0.73	0.55
1-2008683-3	1 Pos LIF TH Poke-In, BLK	0.59	0.44
1-2008683-4	2 Pos LIF TH Poke-In, BLK	0.88	0.65
1954097-1	Poke In SMT,2 Position	0.53	0.40
2008106-1	Connector Asy,2 Pos Through Hole Poke-In	0.60	0.45
2008563-1	Connector,1 Pos SMT Poke-In	0.39	0.29
2008839-1	Connector,1 Pos Through -Hole Poke-In	0.41	0.31
2008994-1	SMT Poke-In,1 Pos,Sealed Connector	0.61	0.45
2008995-1	Thru-Hole Poke-In,1 Pos,Sealed Connector	0.60	0.45
2008996-1	Thru-Hole Poke-In,2 Pos,Sealed Connector	2.22	1.65
1-2058299-1	Blade Wire-to-Board	0.32	0.24
1-2058703-1	Blade Board-to-Board	0.45	0.33
1-1954289-3	Blade and Rcpt 6 pos Black	1.42	1.10
1954289-2	Blade and Rcpt 4 pos White	0.86	0.64
1954785-1	SMT Poke-In 2 Pos Sealed	0.52	0.39



2106053



2106111



2106135

TYCO		1.30	0.97
2106053-2	Connectors Assembly Vertical SMT 2P	1.30	0.97
2106053-4	Connectors Assembly Vertical SMT 4P	1.71	1.27
2106111-4	Connectors Assembly Right Angle TH 4P	1.12	0.84
2106111-6	Connectors Assembly Right Angle TH 6P	1.23	0.92
2106135-2	SlimSeal; Gender - Plug 2P	1.65	1.23
2106135-3	SlimSeal; Gender - Plug 2P	1.71	1.27
2106135-4	SlimSeal; Gender - Plug 2P	1.78	1.33

13. AL PCB

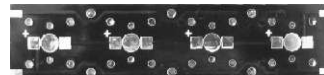

SSL IDC



BOARD TO BOARD

PCB-	AL - PCB	1+	100+
P10-LEDV1	AL pcb za 1W i 3W 142x35mm	10	3
P18-LEDV2	AL pcb za 1W PLED za TAG111 profil	8	2

14. TERMALNE PASTE I LEPKOVI

LLTH-	Termal paste – Aavid Thermalloy	1+
159900F	Ther-O-Bond 1500 Termalna pasta	104
200000F	Ther-O-Bond 2000 Akrlini lepak	79
250G	Ther-O-Link 1000 Termalna pasta	3
349G	Thermalcote II Termalna pasta	3
350G	Thermalcote II Termalna pasta	4



HTCP20S



LLTH-250G

RAZ-	Termalne paste i lepkovi	1+
HTCP20S	Termalna pasta 20ml	14

15. NOSAČI - PLED



2008675-1 STAR BOARD HOLDER KIT+DIFUZOR+TERMAL PAD

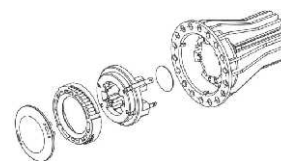

LLHL-	AL nosac za star-PLED	1+	100+
2008675-1	Star board holder kit	20	12
2008671-1	Difuzir za star board holder kit	4	3
2058329-1	Termal pad za star board holder kit	0.5	0.3

16. AL PROFILI I HLADNJACI

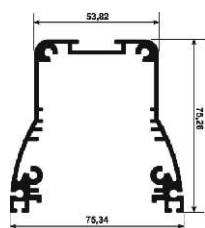

TAG100

LLHL-	AL profil za LED LIGHT	1+	15+
TAG100	AL profil (VxSxD):76mmx76mmx1000mm	23.70	17.70
TAG100-A	Metalni poklopac za bočne strane	Uz Al profil	
TAG100-B	Gumeni zaptivač	Uz Al profil	
TAG100-C	Gumeni zaptivač	Uz Al profil	

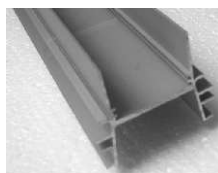

TAG130

LLHL-	AL profil za LED LIGHT	1+	15+
TAG130	AL profil (VxSxD):54mmx60mmx1000mm	13.85	10.34

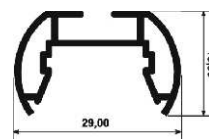
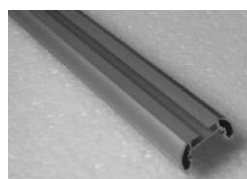

TAG101

LLHL-	AL profil za LED LIGHT	1+	15+
TAG111	AL profil (VxSxD):18mmx29mmx1000mm	4.18	3.12
TAG111-A	Metalni poklopac za bočne strane	Uz Al profil	
TAG111-B	Gumeni zaptivač	Uz Al profil	

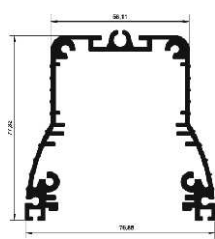

TAG101

LLHL-	AL profil za LED LIGHT	1+	15+
TAG101	AL profil (VxSxD):78mmx78mmx1000mm	26.84	20.00
TAG101-A	Metalni poklopac za bočne strane	Uz Al profil	

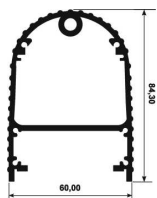
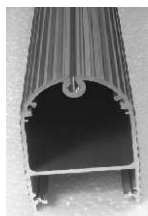

TAG102

LLHL-	AL profil za LED LIGHT	1+	15+
TAG102	AL profil (VxSxD):85mmx60mmx1000mm	28.68	21.42
TAG102-A	Metalni poklopac za bočne strane	Uz Al profil	
TAG102-B	Metalni poklopac za bočne strane	Uz Al profil	
TAG102-C	Gumeni zaptivač	Uz Al profil	

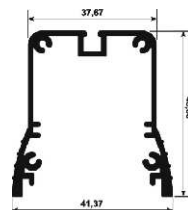

TAG103

LLHL-	AL profil za LED LIGHT	1+	15+
TAG103	AL profil (VxSxD):49mmx48mmx1000mm	11.07	8.26
TAG103-A	Metalni poklopac za bočne strane	Uz Al profil	
TAG103-B	Metalni poklopac za bočne strane	Uz Al profil	
TAG103-C	Gumeni zaptivač	Uz Al profil	
TAG103-D	Gumeni zaptivač	Uz Al profil	

17.AL - ULIČNA RASVETA



TAGSL107

24 W



TAGSL108

48 W

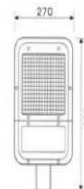

TAGSL111

96 W

LLHL-	AL profil za uličnu rasvetu	1+	100+
TAGSL107	AL Kućište 494x210mm, 24W	117	87
TAGSL108	AL Kućište 800x300mm, 48W	278	207
TAGSL111	AL Kućište 600x270mm, 96 W	162	121

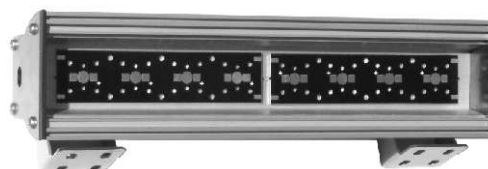

LED pendant 220V

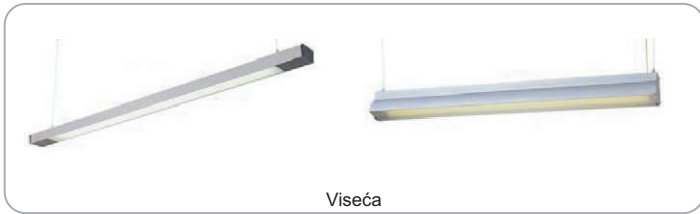

Viseća

OEPLED	LED Pendant 220V	1+
WLP-108X7-XW	1084x74x42mm; 1080lm max	71
PLP-118X12-XW	1180x120x115mm, 2800lm max	133

X = P – pure white; D – daylight white; W – warm white

LED panel light



Viseća

Ugradna

Podna

OEPLED	LED panel light	1+
Pendant panel light		
ULP-60X60-XW	176pcs LED, 600x600mm, 4400lm max	328.
ULP-30X60-XW	84pcs LED, 300x600mm, 1440lm max	162
ULP-30X120-PW	176pcs LED, 300x1200mm, 4400lm max	336
Ceiling panel light		
Ceiling light CRT	45W, 600x600mm; 3500lm max	173
ULP-30X30-PW	Pure white, ceiling, 300x300mm, 2000lm max	113
ULP-30X60-PW	Pure white, ceiling, 300x600mm, 2200lm max	196
Recessed panel light		
RPL-60X60-XW	100pcs LED, 300x300mm, 1500lm max	113
RPL-30X60-XW	196pcs LED, 300x600mm, 2940lm max	203
RPL-30X120-XW	324pcs LED, 300x1200mm, 4860lm max	405

X = P – pure white; D – daylight white; W – warm white

LED street light / tunnel light 220V

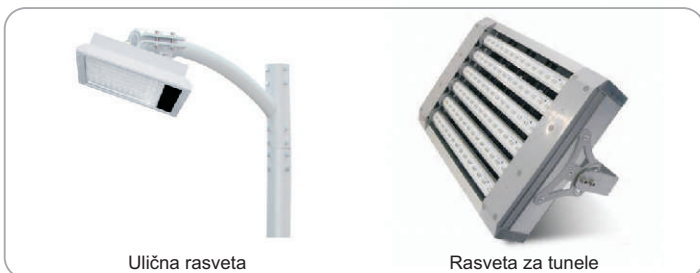

Ulična rasveta

Rasveta za tunele

OEPLED	LED Street light / Tunnel light 220V	1+
Street light		
STL-402	120x1W, 8500lm, 5500K, 120x90°	
Tunnel light		
TNL-802	90W, 9500lm, 84 LED pcs, 90lm/W max	

cool white, warm white

LED downlight 220V



Ugradna

OEPLED	LED Downlight 220V	1+
RDL-1X5X1W-XW	5x1W, 190x190mm, 65-80lm/W max	29
RDL-2X5X1W-XW	2x (5x1W), 335x190mm, 65-80lm/W max	50
RDL-4X5X1W-XW	4x (5x1W), 335x335mm, 65-80lm/W max	94

X = P – pure white; D – daylight white; W – warm white

LED downlight 220V



Viseća

OEPLED	LED Downlight 220V	1+
PDL-2X5X1W-XW	2x (5x1W), 33.5x19mm, 65-80lm/W	58
PDL-4X5X1W-XW	4x (5x1W), 35.5x35.5mm, 65-80lm/W	98

X = P – pure white; D – daylight white; W – warm white

LED downlight 220V



Viseća

OEPLED	LED Downlight 220V	1+
PDL-3X5X1W-XW	3x (5x1W), 156x310x310mm, 65-80lm/W	call
PDL-4X5X1W-XW	4x (5x1W), 168x310x310mm, 65-80lm/W	call

X = P – pure white; D – daylight white; W – warm white

LED pendant / wall mounted 220V

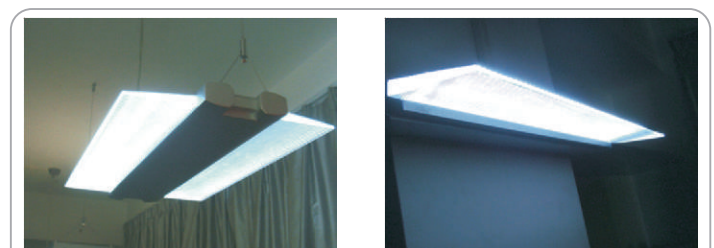

Viseća

Zidna

OEPLED	LED 220V	1+
Pendant		
PLP-61X36-XW	610x375x28mm, 2200lm max	190
Wall mounted		
WLP-20X62-XW	620x196x42mm, 900lm max	82

X = P – pure white; D – daylight white; W – warm white



KOMPONENTE ZA LED RASVETU



LED

TECHNOLOGIES

TAGOR

www.tagor.rs

18000 Niš, T. Brankovića 21
Tel.fax: +381 18 575 545, 217 125

11070 N.Beograd, Bul.Mihajla Pupina
YBC 10 D, nisko prizemlje, Lok. 17
Tel.fax: +381 11 301 6347

